

This device complies with Part 15 of the FCC Rules.

Operation is subject to the following two conditions:

1. this device may not cause harmful interference,
2. this device must accept any interference received, including interference that may cause undesired operation.

RoSH **FC** **CE**



MADE IN CHINA

PRIVATE SITUATIONAL THEATRE

— USER MANUAL

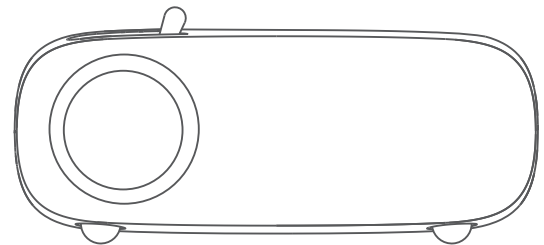

ENGLISH

PACKING LIST

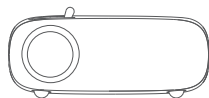

1 Projector



2 Remote



3 User Manual



4 AV Cable

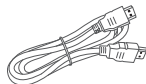

5 HD Cable

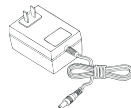

6 Power

FUNCTION OVERVIEW

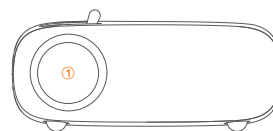
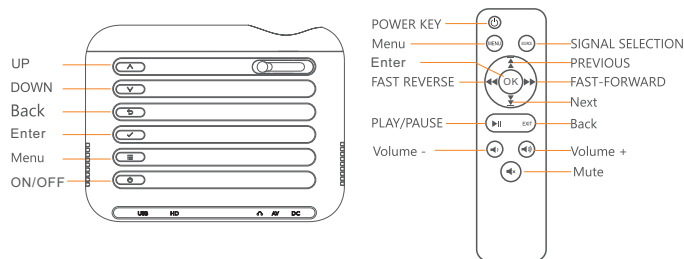

1 Camera Lens

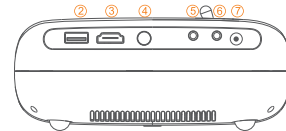

2 USB 3 HD IN 4 Remote receiver
5 Audio Out 6 AV IN 7 Power in Put

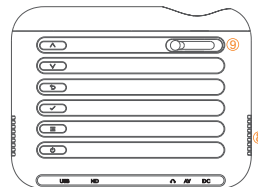

8 Speaker 9 Focus

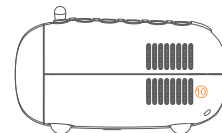

10 Air outlet

QUICK START

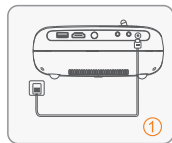

- ① Plug the power cord into an outlet.
- ② Connect your device to the projector correctly.
- ③ Press the power button to turn on the projector.
- ④ Choose the right type of program to play.
- ⑤ Adjust the focus ring to get the best image performance.

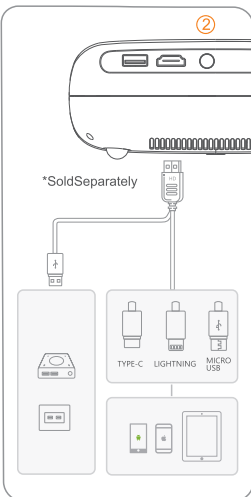
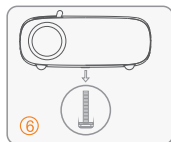
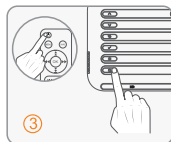

- ⑥ Adjust the kickstand accordingly.
- ⑦ Press the power button twice to turn off the projector.

INPUT SOURCE

A Multimedia Connection

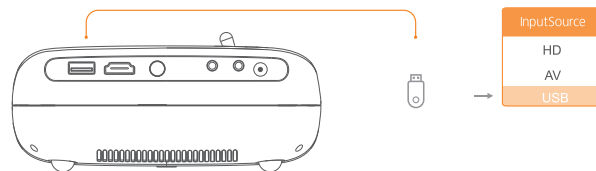

B HD Connection

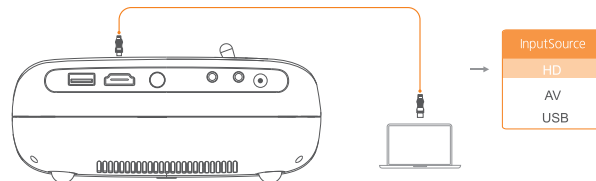

C AV Connection

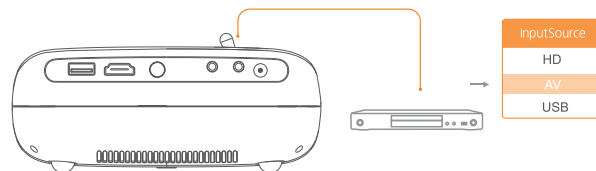

PROJECTOR CONNECTION

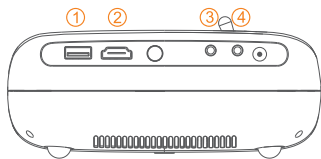

PROJECTION DISTANCE&SIZE

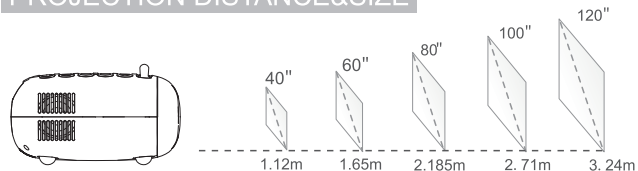

SPECIFICATION

Display Technology	Light Source	Native Resolution	Resolution Supported
LCD	LED	1280*720	576i 576P 720i 720P 1080i 1080P

Projection Distance	Projection Size	Focus	Aspect Ratio
1.1m-5.0m	32"-176"	Manual	4:3/16:9/auto

Speaker	Total power	Unit Dimension	Installation Type
3W*4ohm	50W	158*120*62mm	Front/Rear/Ceiling

Power Supply	Unit Net Weight	Video Format Supported	Photo Format Supported
DC 19V-3A	0.48Kg	AVI/MP4/MKV/FLV/MOV/ RMVB/3GP/MPEG1/ MPEG2/H.264/XVID	BMP/JPG/JPEG/PNG/GIF

Audio Format Supported	Ports		
MP2/MP3/PCM/FLAC/ WMA/AAC	HD IN*1 USB*1/ AV IN*1 Audio Out*1		

NOTICE

VIDEO
MOVIE

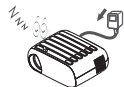

Recommended



NOT
Recommended

TROUBLESHOOTING GUIDE

1.BlurryImage

- * Adjust focus ring
- * Projector and screen/wall must be in effective distance.

2.Remote Unresponsive

- *Make sure remote points at IR receiver directly.
- *Do not cover IR receiver.
- *Replace the battery.

3.Mobile Connection

ios: Genuine lightning to HD cable.

Android: Micro USB to HD adapter/Type C to HD cable.

4.Upside DownImages

Enter "Menu" on projector or remote to flip the projection image.